



## **IMPACT DROPLOCK SPC EXTRUDED RIGID CORE Luxury Vinyl Plank Installation Instructions**

**PLEASE READ ALL INSTALLATION INSTRUCTIONS CAREFULLY BEFORE YOU BEGIN INSTALLATION.  
IMPROPER INSTALLATION WILL VOID WARRANTY.**

- Always check Impact Rigid Core Luxury Vinyl Plank and Tile panels for defects such as chips and color or sheen differences under well-lit conditions. Also, check that the click channel is clean and free of debris. Always work out of multiple boxes to mix product to achieve proper pattern repeat and color appearance. Color variations between flooring, samples, and replacement material is expected and is not a product defect.
- If the appearance of a board is questionable for either dimensions or appearance, the installer should not use this piece. A replacement carton can be obtained through your dealer in a reasonable time.

**NOTE:** Impact Rigid Core SPC can be installed above, on and below grade. The product may be installed as a floating floor.

Walls, subfloors, and installed floors in buildings and houses move. A minimum of ¼" gap for expansion is recommended between the installed floor and any adjacent perimeter wall, vertical structure, or wood-based floor (laminated or hardwood).

### **Subfloor Preparation**

Impact Rigid Core SPC is a waterproof product. Moisture from the top will not damage the product. When installed, it does not produce a moisture barrier, nor does it protect the walls or structure of the home from moisture. Only installing a moisture barrier Poly 6 mil or Liquid Barrier in a crawl space or under the Impact Rigid Core SPC over a concrete floor can insure this. Please see below Subfloor Requirements section for moisture limits to protect the home from moisture damage.

### **Jobsite Preparation Before Installation**

The responsibility for installation of Impact Rigid Core SPC is with the local job site installer. Every plank and/or tile must be inspected prior to installation for color variation, finish condition, sheen variation, and quality. This inspection should be conducted with proper lighting available. Any boards that are not acceptable should not be installed. Contact your dealer immediately to obtain replacement boards.

FORCEMAX FLOORS is not responsible for the installation of flooring with obvious defects.

It is the responsibility of the local job installer to ensure that the jobsite and subfloor meet the requirements of these installation instructions. FORCEMAX FLOORS is not responsible for failure of this Impact SPC flooring caused by unsatisfactory jobsite and/or subfloor conditions.

Crawl spaces – For the protection of the home, when installing a moisture barrier in a crawl space, minimum crawl spaces of 18” are required from the ground to the underside of the joists. A vapor barrier of 6-20 mil thick polyethylene film with 6” sealed lap joints should be used. Moisture resistant tape should be used as the vapor barrier sealant at the lap joints. Venting for the crawl space should be at least 1.5% of the crawl space square footage. Vents should be located for cross-ventilation of the crawl space. Local regulations should always prevail.

Before floor installation, the room conditions in the installation area (temperature and moisture) should be at normal year-round conditions for at least one week prior to and during flooring installation. Acclimation of Impact Rigid Core SPC is not required before installation.

Recommended installation room conditions are temperatures between 0 to 90 degrees F. Never install below 0 degrees or above 90 degrees F.

### **Removing Old Adhesives**

Asphaltic “cut-back” adhesives can stain Impact SPC flooring. These must be 100% removed, encapsulated or covered with plywood underlayment. Some previously manufactured cutback adhesives contained asbestos fibers, which are not readily identifiable. Do not use power removal devices, which can create dust. The use of solvent-based adhesive removers is never recommended. NOTE: If d-limonene (citrus based) cleaners/removers are used (Orange All), subfloor must be thoroughly rinsed. If complete removal of old adhesives or covering them with plywood is not possible, the use of a Portland Based Leveling or Patching Compound is acceptable. Please follow manufacturer’s instructions carefully.

For “Recommended Work Practices for the Removal of Resilient Floor Coverings” write to the Resilient Floor Covering Institute, 966 Hungerford Dr., Suite12-B, Rockville, MD 20850.

### **Subfloor Requirements**

All subfloors must be dry, structurally sound to support the floor and to protect the home from moisture, free of debris and foreign matter, and flat to 3/16” in a 10-foot radius.

For concrete floors, the subfloor should be firm, flat, dry, and clean. This includes both old and new concrete floors. New concrete slabs must cure in well-ventilated conditions for at least 3 days minimum before installing the floor. Concrete should have a minimum 6-mil poly film moisture barrier between the concrete and Forcemax product. Maximum moisture level per the Calcium Chloride test method is 9 lbs. per 1000 sq. ft. in 24 hours. The maximum level of relative humidity per ASTM 2170 test method is 90%.

Impact Rigid Core SPC subfloors must be dry and properly secured to accept a top floor. The subfloor must be secured every 6" along joists with nails or screws to avoid squeaking. The floor must be leveled and flat. High spots must be ground down and low spots must be filled with a Portland cement leveling compound.

Please note that Impact Rigid Core SPC is not approved for installation over any type of carpet.

**NOTE:** Never install Impact Rigid Core SPC over any type of floating floor. All subfloors that are not concrete must be firmly bonded.

**NOTE:** Never install Impact Rigid Core SPC over a below grade VCT (vinyl composition tile). Tiles including ceramic, resilient, and sheet vinyl must be well bonded to the subfloor, must be level and flat, and must be clean. Existing vinyl floors should not be sanded as they may contain asbestos.

## Installation Tools

Safety Glasses  
Broom/Vacuum  
Rubber hammer  
¼" spacers  
Utility knife or a Circular saw (Recommended)  
Pencil  
Tape measure Ruler

### Acceptable subfloor types:

- CDX Underlayment Grade Plywood (minimum of 5/8" thickness)
- Underlayment Grade Particleboard (only for floating installation)
- OSB (minimum ¾", 23/32" thickness) □ Concrete slab
- Ceramic Tile – one layer well Bonded
- Resilient Tile – one layer well bonded (Not Below Grade)
- Sheet Vinyl – one layer well bonded

### Do not install over:

- Existing resilient tile floors that are below grade
- Existing cushion -backed vinyl flooring
- Carpet
- Hardwood flooring that has been installed directly over concrete
- VCT flooring that has been installed directly over concrete
- In rooms with sloping floors or floor drains

## Before Installation

### Impact Rigid Core SPC

While Impact Rigid Core SPC is dimensionally stable, buildings, walls, and existing hardwood and laminate floors will expand and contract. Because of this, we recommend for all installations, both floating floor and glue down types, that an expansion gap of at least ¼” be left for expansion between Impact SPC, any vertical surface, an adjacent perimeter wall or wood-based floor (laminate or hardwood).

As stated earlier, always work out of multiple boxes to mix product to achieve proper pattern repeat and color mix for the look of natural wood. A minimum of 3 boxes of product is recommended. Inspect each plank or tile in good light for visual defects. If they show visual faults or damage, do not install them. It is the responsibility of the installer to ensure that the appearance of the finished floor meets the consumer’s expectations.

Impact Rigid Core SPC is an **indoor** only product. It will not be warranted when installed in locations or conditions not recommended for this product.

Recommended use temperatures are between 0 to 90 degrees F.

The use of an acceptable underlayment is recommended under the Impact SPC floor in installations where sound abatement is needed. If the product is purchased with attached pad, additional underlayment is not needed. If the product does not have attached pad but needs one to be installed for sound, we recommend the use of an underlayment that comes attached for sound reduction.

## Installation

This Locking system (Unilin Angle T is designed to be installed utilizing the floating method. Always use the proper expansion space. Undercut all doorjambes. Never fasten moldings and or transition strips to the planks.



**Step 1:** Begin installation working from left to right. Insert 1/4" wide spacers at ends and edges where planks meet wall.

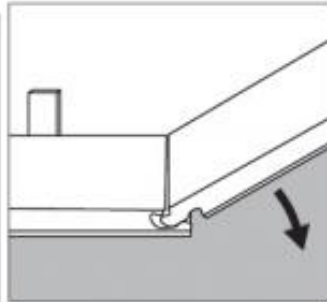

**Step 2:** Lock short end of plank by inserting tongue into groove at an approximate 30 degree angle and drop into place. Continue this process throughout the installation.

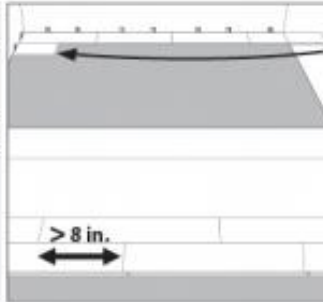

**Step 3:** Use the remaining plank from your cut piece to begin the next row (you will repeat this process throughout the installation). Note: It is recommended that you space end-joints by a minimum of 8 inches.

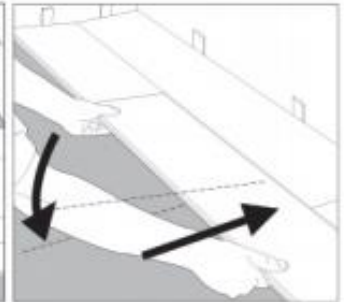

**Step 4:** Lock long edge of plank by inserting tongue into groove at an approximate 15 degree angle and drop into place. Next slide toward end of previously installed plank until the tongue touches the groove.

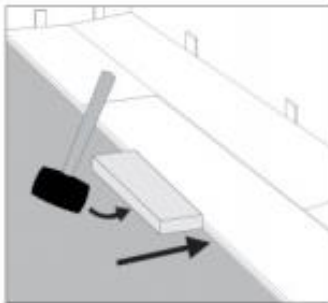

**Step 5: IMPORTANT!** Use a hammer and tapping block to tap the long edge of the plank to ensure a tight fit. Note: Tapping block should be a minimum of 10" to 12" long. It is important to note that any/all gapping can/will compromise the locking system.

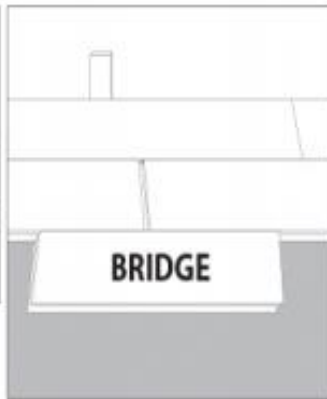

**Step 6:** Attach a scrap piece of floor to bridge gap between ends of planks.

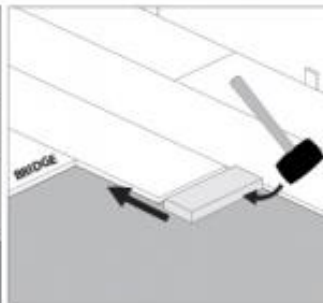

**Step 7:** Tap end of plank with hammer and tapping block to lock ends of planks together. Remove support bridge and continue with this method until you have completed installing the row. Note: BE SURE TO TAP ON EDGE OF VINYL SO AS NOT TO DAMAGE LOCKING PROFILE.



**Step 8:** Use hammer and pull bar to lock final piece in row. Insert spacer at end of row. Continue installation to final row.

Check our website for videos how to install FORCEmax Floors.

- 3.
1. Start in the upper left corner by placing the first plank parallel with its trimmed side facing the wall. Use spacers along each wall to maintain the proper expansion of 1/4".
2. To attach the second plank lower and lock the end tongue of the second plank into the end groove of the first plank. Line up edges carefully and make sure the end joint is flat to the floor.
3. Continue installing the first row until you reach the last plank. Fit the last plank by rotating the plank 180 degrees with the pattern side up. Place beside row mark and cut off the excess. Attach as described above. If using a handsaw, cut on the decorative surface. If you're using a jig or circular saw cut with the decorative side down to avoid chipping.
4. Continue the second row with the cut off piece from the first row to stagger the pattern. Pieces should be a minimum of 30 cm (8") long and joint offset should be 40 cm (16").
5. To start your second row tilt and engage the side tongue of the plank into the groove of the first plank at about 30 degrees.
6. Attach the second plank of the second row first on the long side. Tilt and push the plank as close to the edge of the previous plank at a 30 degree angle. Make sure the edges are lined up and lower the plank to the floor locking the end joint together. Continue installing the remaining planks.
7. To fit the last row lay a plank on top of the previous row. With the tongue facing the wall, Lay another plank upside down on top of the one to be measured and use it as a ruler. Don't forget to leave room for your spacers. Cut and install as described above.
8. Door jams and heating vents also need expansion. First, cut the plank to the correct length including expansion. Then place the cut plank next to its actual position and using a ruler measure the areas to be cut out and mark them. Cut out the marked areas including expansion and install the plank.
9. You can undercut the door casing by turning a plank upside down and using a handsaw cut off the bottom of the door casing. Now your plank will slide easily under the door casing, remember to leave expansion.
10. Install moldings, baseboards or transition strips to any exposed edge of the flooring. Since this is a floating floor, make sure that the planks are not accidentally attached to the subfloor when the molding is installed.
11. Protect the newly installed floor from other trades by covering the finished flooring with an appropriate paper.

## Repairs

Impact Rigid Core SPC flooring is durable; however, planks can be damaged. If the damaged plank is near the perimeter of the room, the best technique is to carefully unlock the planks until the damaged plank

## Finishing Molding

3.



T-Molding



Reducer



Stair Nose



Quarter Round



End-Molding

Reducer molding is used to finish flooring when the adjoining surface is lower than the Impact Rigid Core SPC flooring or when flooring meets carpet. Position the U track 7mm leaving expansion gap of at least ¼" from each edge of the. Screw, nail or glue down the track directly to the subfloor and then insert the reducing strip into the track. (Most of our customers do not use track using 100% silicone glue)

T-molding is used to finish flooring and add expansion when two level surfaces meet in doorways. Install the same as above. Residential Installations do not require the use of T Moldings.

Stairnose molding is used to finish flooring on landings or stair edges. Moldings need to be glued and screwed down to the sub-floor for safety and stability. Color fill should be used to cover counter sunk screws.

To finish the perimeter of the room, install quarter round molding using finishing nails. Quarter round molding is nailed directly into the baseboard or replace the baseboard.

## Radiant Heated Floors

This Impact Rigid Core LVT floor can be installed over certain types of radiant heated floors either as a floating floor or glued down. Follow the manufacturer's installation instructions when full spread installation with an approved glue.

When installing over a radiant heated floor:

1. A newly installed radiant heated floor must be operational for at least four (4) weeks prior to Impact Rigid Core SPC installation with the temperature set between 55 to 85 degrees F to ensure that the subfloor has been dried.
2. Wood subfloors should never exceed 6% moisture content as measured by a calibrated wood moisture meter.  
Concrete subfloors must be "dry" using the mat test, a calibrated concrete moisture meter, Calcium Chloride Test or a RH Probe.
4. Ground floors using the radiant heating system should have a proper moisture barrier beneath it.
5. The recommended range of relative humidity is 45%-95% and the room temperature should be between 55-85 degrees F.
6. Keeping the temperature of the room constant will keep a stable environment for the home.
7. The floor surface temperature must always stay below 85 degrees F.

- 3.
8. At no time should the relative humidity in the room drop below 30% to keep a stable environment for the home.

**NOTE:** Electrically heated radiant mats not embedded in the subfloor and installed directly under this Impact Rigid Core LVT are not recommended for use beneath this product. The installation of electrically heated radiant floor heating mats could void the warranty of the installed floor in case of a heating system failure.

## Steam Cleaners

Forcemax Floors does not recommend the use of any type of steam cleaner on our floors. These types of cleaners generate too much moisture and heat during their use. The resulting moisture and heat can be enough to break down any adhesives used in the manufacturing of this product. Also, in instances where no glue is used, both peaked and swelled plank or tile edges can occur. Therefore, all complaints that are determined to be from a consumer using a steamer will be denied by Forcemax Floors.

## Warranty Information Impact Rigid Core LVT Floors Exclusive Limited Warranty

Forcemax Floors warrants that its Impact Rigid Core planks and tiles are free from any visual or manufacturing defects. If the Products are found to be defective, Forcemax will supply new Product of the same or similar style, size, color, grade, and gauge to repair or replace the defective area and will pay reasonable labor costs provided the flooring is professionally installed and maintained according to the installation instructions provided. Products that are non-defective but are damaged during an improper installation by not following the Elite Flooring installation guidelines do not constitute a valid claim as defined by this limited warranty. This warranty will not include loss of time, inconvenience, incidental expenses (such as telephone calls, removal and replacement of items placed over the floor after the original installation, etc.) included in the removal and reinstallation of the affected material, and any other incidental or consequential damages. Forcemax reserves the right to inspect any claim and/or request photographs and/or samples associated with the specific claim prior to approving any claim. All limited warranties are valid for the original purchaser of the flooring only and are not transferrable.



## **Pre-Installation Visual Limited Warranty**

Forcemax Floors warrants that its Impact Rigid Core plank and tiles products are free from visual defects. All Product purchased for an installation should be inspected by you and/or your installer. Pieces that appear to be visually defective should not be installed. Forcemax Floors will not be responsible for reimbursing labor charges on any claim for visually defective product installed. It is the responsibility of the installer to determine the suitability of the product for installation before it is installed.

If a problem occurs during the installation of the planks and tiles, the job should be stopped immediately. The proper action is to immediately report the problem to your dealer and distributor who, in turn, will contact Forcemax Floors immediately. Any costs caused by continued installation after the problem is reported will not be covered by Forcemax Floors.

## **Wear Limited Warranty**

Forcemax Floors Impact Rigid Core SPC planks and tiles are protected with a wear layer. Forcemax Floors warrants that there will be no wear-through of the wear layer for the number of years indicated for the specific product. "Wear-through" means complete loss of the wear layer so that the printed color layer is changed or affected. The term for your specific product wear Limited Warranty will appear on the insert of the product you purchased. This Limited Warranty applies only to first quality merchandise provided the recommended installation and maintenance procedures are followed as outlined in the Installation Instructions and Owner's manual.

## **Pet Warranty**

Forcemax Floors Impact planks and tiles are warranted to resist stains caused by pet soiling from domestic dogs and cats during the specific warranty time frame. The pet stains include urine, feces, and vomit. Resisting stains means that your floor has the ability to minimize or hold out permanent stains under the conditions stated. Pet accidents should be cleaned up immediately, as the longer they sit, the more difficult they will be to remove. Any damage to the subfloor and/or surrounding structure caused by pet soiling is not covered by this warranty. Please follow our maintenance procedures for cleaning the affected areas. This warranty does not cover soiling and staining caused by any other pet type besides those stated above.

## **Waterproof Limited Warranty**

Forcemax Floors Impact Rigid Core SPC planks and tiles are warranted to be 100% waterproof. The structural performance of the planks or tiles, when properly installed and under normal use conditions, will be resistant to damage caused by exposure to water for the life of the product.

Mold and/or mildew can sometimes occur in a building if moisture issues are not addressed. This moisture warranty excludes damage resulting from the growth of both mold and/or mildew due to extended moisture exposure.

While Impact Rigid Core SPC planks and tiles are waterproof, the floor is not a waterproof barrier for the subfloor and surrounding structure. The Moisture warranty does not cover damage caused by hydrostatic pressure from the subfloor, flooding, household leaks (such as pipes), or mechanical failures like appliance and heating equipment leaks.

If the Impact Rigid Core SPC planks and tiles are structurally damaged and the cause is determined to be by exposure to water, Elite will arrange a credit subject to the terms as described below in the “Terms of Lifetime Limited Warranty” section. The term for your specific residential product Limited Warranty will appear in the carton insert of the product you purchased. For commercial installations, Impact Rigid Core SPC planks and tiles damaged caused by exposure to water will be subject to a pro-rated credit as described below in the “Terms of Lifetime Limited Warranty” section.

### **Waterproof Limited Warranty does not cover:**

1. Any damage to structures that are not part of the installed Impact Rigid Core SPC flooring such as damage to surrounding walls, subfloor, structures, fixtures, furniture, underlayment, moldings, trims, and subfloor heating systems, or anything that is not the tile or plank.
2. Any damage from mold and/or mildew growth due to extended water exposure.
3. Flooring that is installed outdoors.

### **Flooring Underlayment:**

Impact Rigid Core SPC

Forcemax Floors Impact Rigid Core SPC flooring is warranted to be free of manufacturing defects and to be structurally sound with or without underlayment pad. If underlayment pad is installed, Impact Rigid Core SPC is structurally warranted only when using Forcemax Floor’s specially designed underlayment. The use of any other pad will void the structural Integrity warranty and retain the manufacturing defects warranty.

### **Terms of Limited Lifetime Commercial Warranties:**

Claims reported on material defects of this Impact Rigid Core LVT flooring will be prorated over the life of the product. Reasonable labor costs will be paid with the following exceptions:

- Claims reported before 1 year of use will pay labor charges at the rate of 50% reasonable labor charges.
- Claims reported after 1 year of use will not pay labor charges.

This warranty shall not include loss of time, inconvenience, incidental expenses (such as telephone calls and removal and replacement of items placed over the floor after the original installation) included in the removal or reinstallation of the affected flooring materials, and any other incidental or consequential damages.

This warranty is in lieu of any other warranties expressed or implied.

This warranty service is available only by notice to your distributor through the dealer from whom the purchase was made. Notification must be accompanied by a copy of the original invoice and can only be authorized by your distributor.

## **Limited Warranty Exclusions and Conditions**

- Commercial use means daily activities commonly associated with a commercial environment. Hill Rom Beds are not recommended.
- Warranty coverage for any replacement flooring planks will be limited to the remaining time of the original warranty
- Warranty coverage does not apply to seconds, off-quality, or “as-is” goods.
- Warranty coverage applies only to the original purchaser of the flooring and the original installation site, is non-transferrable, and prorated by time of use.
- Warranty coverage does not apply to conditions or defects caused by improper installation, the use of improper materials during installation, or inadequate sub-flooring preparation as described in the Owner’s Manual.
- Warranty does not apply to floors with alkalis in the sub-floor or conditions arising from hydrostatic pressure or flooding.
- Warranty does not apply to damages or failure of the floor to adhere to the subfloor resulting from excessive moisture, alkali and/or hydrostatic pressure.
- Warranty coverage does not apply to construction-related damage.
- Warranty coverage does not apply to color variations between samples or printed illustrations and the actual production runs.
- Warranty coverage does not apply to reduction of gloss from use or improper maintenance.
- Warranty coverage does not apply to product sold through unauthorized dealers.
- Warranty coverage does not apply to conditions caused by using steam cleaners.

- Warranty does not apply to damage that results from not following floor maintenance instructions
- Warranty does not apply to damages resulting in scuffs, scratches, cuts, staining from rubber-backed mats, or damages or discoloration from carpet dyes, fertilizer, asphalt from driveways or chemicals.
- Warranty does not apply to damages caused by burns, flooding, fires, and other accidents.
- Warranty does not apply to damage caused by abuse (such as dragging heavy or sharp objects across the floor without proper protection for the floor or with heavy wheeled vehicle traffic that can permanently indent or damage the flooring).
- Warranty does not apply to damage caused by caster wheels or vacuum cleaner beater bars.
- Warranty does not apply to failure to support furniture with floor protectors made of non-staining felt or non-pigmented hard plastic.
- Warranty does not apply to discoloration from heat or sunlight.
- “Wear-Through” means complete loss of the wear layer so that the printed pattern or design of the floor is altered.
- “Residential use” means daily activities commonly associated with residential use.

If you have any questions regarding the above information, please contact your local flooring dealer or distributor.

## **Care and Maintenance Impact SPC Floors**

Once the floor has been installed, vacuum or use a dust mop to clear the floor of any loose dirt or residual dust or debris. The floor can be wiped with neutral pH cleaners or water.

Furniture should have felt pads attached to the feet to avoid scratching the floor. Heavy appliances or furniture should sit on non-staining large surface flooring protectors.

When furniture has castors or wheels on the feet, they must be suitable for resilient floors, large surface non staining, and swivel easily. Do not use ball-type castors because they can damage the floor. Castor wheels should be equipped with wide, rubber castors.

Protective matts should be non-staining as rubber mats may discolor the floor. All furniture pieces should have floor protectors under them.

Walk-off mats should be used in entrances to help prevent dirt from being carried onto the floor.

Regularly sweep or vacuum the floor to remove dirt and dust. Do not use a vacuum with a beater bar to vacuum the floor as this can cause floor scratches.

Do not use hard bottomed electric brooms without padding as they can scratch the floor.

Forcemax Floors does not recommend the use of any type of steam cleaner on our floors. The concern with these types of cleaners is that they generate too much moisture and heat. If adhesive was used the resulting moisture and heat can be enough to break down the adhesive. Also, in instances where no glue is used, we have seen both peaked and swelled edges occur. Therefore, all complaints that are determined to be from a consumer using a steamer will be denied by Forcemax Floors.

If pet urine contacts the floor, it should be cleaned in a timely manner. If the floor is not cleaned and the urine removed, it may dull the finish.

Liquid spills and any wet areas should also be cleaned in a timely manner. The floor can be damp mopped with clean warm water and a dilute floor cleaner as needed. Do not use harsh cleaners or chemicals, abrasive scrubbing pads, abrasive tools, or abrasive cleaners as they can scratch the floor. Do not use detergents and do not use floor shining products like "mop and shine" types on the floor.

Petroleum-based products can stain the surface of your vinyl floor. These include materials like asphalt driveway sealer and engine motor oil, among others.